

**Non-Insulated Core End Terminals**

Brand	KF <sup>®</sup>
Finish/Coating	Tinned
Base Materials	Copper
Insulation Material	N/A
Brazed	Seam
Wire/Cable Type	Regular Wire
Color Code	Standard
MOQ	1000Pcs/item
Payment Terms	Based on orders
Delivery	FOB/CIF/DDP

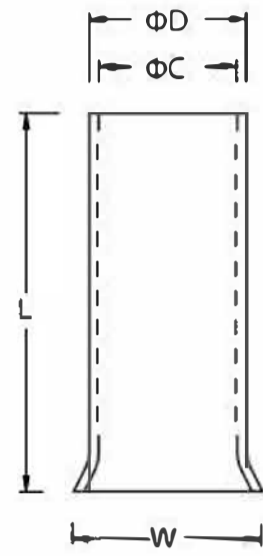

Spec (American AWG)	5	7.5	10	15	25	40	60	10-16	25-35	50-		
Spec (JIS AWG)												
Spec (DIN AWG)												
Spec (GB mm <sup>2</sup> )												
Max Current	9	12	17	18	30	35	50	70	95	125	170	230
Operating Voltage	600V											
Temperature Withstand	105°C											



Wire Range	SKU#	MFG#	Dimension(mm)								Tool	pcs/pack
			L		W		D		C			
A.W.G. 22 0.5mm <sup>2</sup>	KFC1O10	EN0506	0.236	6.0	0.073	1.85	0.051	1.3	0.039	1.0	OPT AN-04WF	2000
	KFC1O11	EN0508	0.315	8.0	0.073	1.85	0.051	1.3	0.039	1.0		2000
	KFC1O12	EN0510	0.394	10.0	0.073	1.85	0.051	1.3	0.039	1.0		2000
	KFC1O13	EN0512	0.472	12.0	0.073	1.85	0.051	1.3	0.039	1.0		2000
A.W.G. 20 0.75mm <sup>2</sup>	KFC1O20	EN7506	0.236	6.0	0.081	2.05	0.059	1.5	0.047	1.2	OPT AN-04WF	2000
	KFC1O21	EN7508	0.315	8.0	0.081	2.05	0.059	1.5	0.047	1.2		2000
	KFC1O22	EN7510	0.394	10.0	0.081	2.05	0.059	1.5	0.047	1.2		2000
	KFC1O23	EN7512	0.472	12.0	0.081	2.05	0.059	1.5	0.047	1.2		2000
A.W.G. 18 1mm <sup>2</sup>	KFC1O30	EN1006	0.236	6.0	0.093	2.35	0.067	1.7	0.055	1.4	OPT AN-04WF	2000
	KFC1O31	EN1008	0.315	8.0	0.093	2.35	0.067	1.7	0.055	1.4		2000
	KFC1O32	EN1010	0.394	10.0	0.093	2.35	0.067	1.7	0.055	1.4		2000
	KFC1O33	EN1012	0.472	12.0	0.093	2.35	0.067	1.7	0.055	1.4		2000
A.W.G. 16 1.5mm <sup>2</sup>	KFC1O40	EN1508	0.315	8.0	0.104	2.65	0.079	2.0	0.067	1.7	OPT AN-04WF	2000
	KFC1O41	EN1510	0.394	10.0	0.104	2.65	0.079	2.0	0.067	1.7		2000
	KFC1O42	EN1512	0.472	12.0	0.104	2.65	0.079	2.0	0.067	1.7		2000
	KFC1O43	EN1518	0.709	18.0	0.104	2.65	0.079	2.0	0.067	1.7		2000
A.W.G. 14 2.5mm <sup>2</sup>	KFC1O50	EN2508	0.315	8.0	0.132	3.35	0.102	2.6	0.091	2.3	OPT AN-04WF	2000
	KFC1O51	EN2510	0.394	10.0	0.132	3.35	0.102	2.6	0.091	2.3		2000
	KFC1O52	EN2512	0.472	12.0	0.132	3.35	0.102	2.6	0.091	2.3		2000
	KFC1O53	EN2518	0.709	18.0	0.132	3.35	0.102	2.6	0.091	2.3		1000
A.W.G. 12 4mm <sup>2</sup>	KFC1O60	EN4009	0.354	9.0	0.161	4.10	0.124	3.15	0.11	2.8	OPT AN-10WF	1000
	KFC1O61	EN4012	0.472	12.0	0.161	4.10	0.124	3.15	0.11	2.8		1000
	KFC1O62	EN4018	0.709	18.0	0.161	4.10	0.124	3.15	0.11	2.8		1000
A.W.G. 10 6mm <sup>2</sup>	KFC1O70	EN6010	0.394	10.0	0.187	4.75	0.152	3.85	0.138	3.5	OPT AN-10WF	1000
	KFC1O71	EN6012	0.472	12.0	0.187	4.75	0.152	3.85	0.138	3.5		1000
	KFC1O72	EN6018	0.709	18.0	0.187	4.75	0.152	3.85	0.138	3.5		1000
A.W.G. 8 10mm <sup>2</sup>	KFC1O80	EN10-12	0.472	12.0	0.236	6.00	0.199	5.05	0.185	4.7	OPT AN-16WF	1000
	KFC1O81	EN10-18	0.709	18.0	0.236	6.00	0.199	5.05	0.185	4.7		1000
A.W.G. 6 16mm <sup>2</sup>	KFC1O90	EN16-12	0.472	12.0	0.287	7.30	0.242	6.15	0.228	5.8	OPT AN-16WF	1000
	KFC1O91	EN16-18	0.709	18.0	0.287	7.30	0.242	6.15	0.228	5.8		1000
A.W.G. 4 25mm <sup>2</sup>	KFC1OA0	EN25-16	0.63	16.0	0.358	9.10	0.305	7.75	0.291	7.4	OPT AN-50WF	500
	KFC1OA1	EN25-22	0.866	22.0	0.358	9.10	0.305	7.75	0.291	7.4		500
A.W.G. 2 35mm <sup>2</sup>	KFC1OB0	EN35-16	0.63	16.0	0.398	10.10	0.343	8.7	0.329	8.35	OPT AN-50WF	500
	KFC1OB1	EN35-25	0.984	25.0	0.398	10.10	0.343	8.7	0.329	8.35		500
A.W.G. 1/10 50mm <sup>2</sup>	KFC1OC0	EN50-20	0.787	20.0	0.504	12.80	0.429	10.9	0.415	10.55	OPT AN-50WF	200
	KFC1OC1	EN50-25	0.984	25.0	0.504	12.80	0.429	10.9	0.415	10.55		200