

Nylon-Insulated Piggyback Quick Disconnectors

Brand	KF [®]
Finish/Coating	Tinned
Base Materials	Brass, Nylon
Insulation Material	N/A
Brazed	Seam
Wire/Cable Type	Regular Wire
Color Code	Standard
MOQ	1000Pcs/item
Payment Terms	Based on orders
Delivery	FOB/CIF/DDP

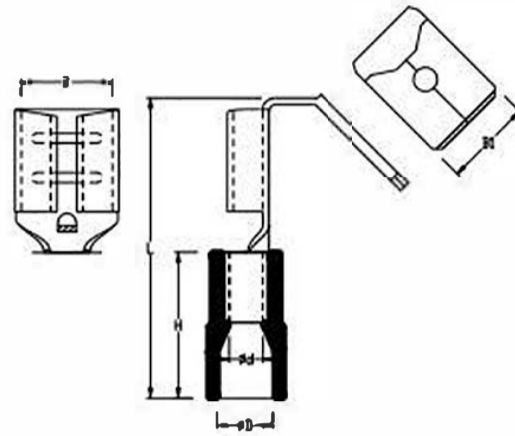

Spec (American AWG)	22-16	16-14	12-10
Spec (JIS AWG)	1.25	2	5.5
Spec (DIN AWG)	1	2.5	4.0-6.0
Spec (GB mm ²)	0.5-1.5	2.5	6
Max Current	10	15	24
Operating Voltage	600V		
Temperature Withstand	105°C		

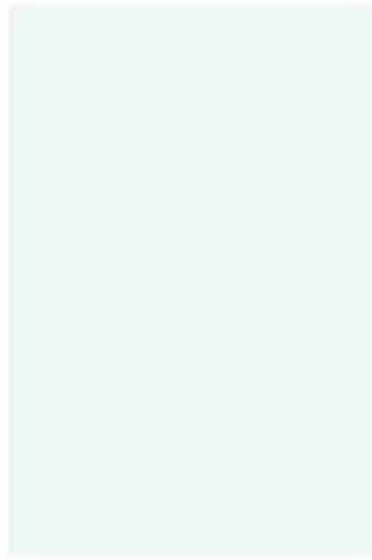

Wire Range	SKU#	MFG#	Dimension(mm)														Color	Tool	pcs/pack
			B		B1		H		D		d		L		T				
A.W.G. 22-16 0.5~1.5mm ²	KFQNP10	PBDNY 1.25-250	0.256	6.5	0.25	6.4	0.413	10.5	0.157	4.0	0.079	2.0	0.886	22.5	0.016	0.4	red	IZUMI 3#	1000
A.W.G. 16-14 1.5~2.5mm ²	KFQNP20	PBDNY 2-250	0.256	6.5	0.25	6.4	0.413	10.5	0.177	4.5	0.098	2.5	0.886	22.5	0.016	0.4	blue	IZUMI 4#	1000
A.W.G. 12-10 4~6mm ²	KFQNP30	PBDNY 5.5-250	0.256	6.5	0.25	6.4	0.531	13.5	0.276	7.0	0.138	3.5	1.004	25.5	0.016	0.4	yellow	IZUMI 5#	500