

Copper Tubular Lugs (Type TM)

Copper Tubular Lugs

Brand	KF®
Finish/Coating	Tinned
Base Materials	Copper
Insulation Material	N/A
Brazed	Seam
Wire/Cable Type	Regular Wire
Color Code	Standard
MOQ	1000Pcs/item
Payment Terms	Based on orders
Delivery	FOB/CIF/DDP

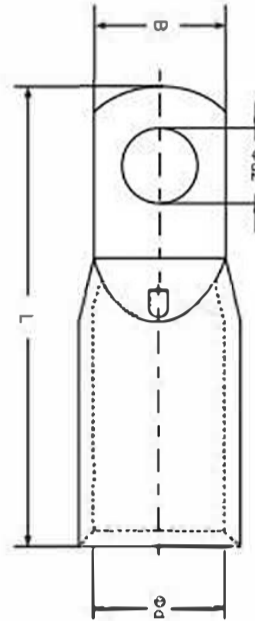

Spec(American AWG)	8	6	4	2	1/0	2/0
Spec(JIS AWG)	10	16	25	35	50	70
Spec(DIN AWG)						
Spec(GB mm²)						
Max Current	70	95	125	170	230	265
Spec(American AWG)	3/0		4/0	250/300MCM	300/350MCM	
Spec(JIS AWG)	95		120	150	185	
Spec(DIN AWG)						
Spec(GB mm²)						
Max Current	310		360	445	505	



Wire Range	SKU#	MFG#	Stud Size		Dimension(mm)								Tool	pcs/pack
			USA	Meric	d2	B	L	d						
A.W.G. 8 10mm²	KFLTM10	TM10-5	#10	5	0.209	5.3	0.354	9.0	1.063	27.0	0.169	4.3	IZUMI 5N18	500
A.W.G. 6 16mm²	KFLTM20	TM16-5	#10	5	0.209	5.3	0.354	9.0	1.22	31.0	0.22	5.6	OPT TP-150D	500
A.W.G. 4 25mm²	KFLTM30	TM25-5	#10	5	0.209	5.3	0.354	9.0	1.378	35.0	0.276	7.0	OPT TP-150D	250
A.W.G. 2 35mm²	KFLTM40	TM35-6	1/4"	6	0.252	6.4	0.453	11.5	1.594	40.5	0.331	8.4	OPT TP-150D	200
A.W.G. 1/0 50mm²	KFLTM50	TM50-8	5/16"	8	0.331	8.4	0.504	12.8	1.791	45.5	0.374	9.5	OPT TP-150D	100
A.W.G. 2/0 70mm²	KFLTM60	TM70-8	5/16"	8	0.331	8.4	0.504	12.8	1.929	49.0	0.441	11.2	OPT TP-150D	100
A.W.G. 3/0 95mm²	KFLTM70	TM95-8	5/16"	8	0.331	8.4	0.61	15.5	2.126	54.0	0.531	13.5	OPT TP-150D	50
A.W.G. 4/0 120mm²	KFLTM80	TM120-8	5/16"	8	0.331	8.4	0.748	19.0	2.677	68.0	0.614	15.6	IZUMI EP-520C	30
	KFLTM81	TM120-10	3/8"	10	0.413	10.5	0.748	19.0	2.677	68.0	0.614	15.6		10
A.W.G.250/300MCM 150mm²	KFLTM90	TM150-8	5/16"	8	0.331	8.4	0.748	19.0	2.953	75.0	0.657	16.7	IZUMI EP-520C	10
A.W.G.300/350MCM 185mm²	KFLTMA0	TM185-10	3/8"	10	0.413	10.5	0.965	24.5	3.11	79.0	0.748	19.0	IZUMI EP-520C	10